

INSTALLATION INSTRUCTIONS FOR

CARRIER 3A (CAS PART #1002132)

CARRIER 4A (CAS PART #1002134)

POWER EXHAUST

**NOTE: POWER EXHAUST COMPATIBLE WITH ECONOMIZER
IN DOWNSHOT CONFIGURATION ONLY**

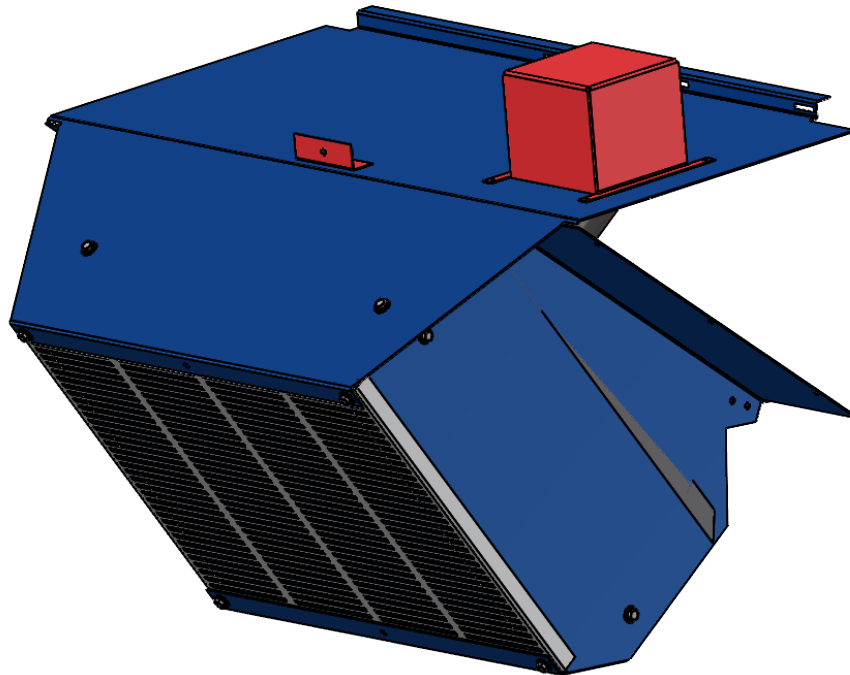

CAUTION

**DISCONNECT POWER SUPPLY BEFORE CONNECTING WIRING
TO PREVENT ELECTRICAL SHOCK OR EQUIPMENT DAMAGE**

READ COMPLETELY BEFORE INSTALLING!!!

CAMBRIDGEPORT IS NOT RESPONSIBLE FOR IMPROPERLY INSTALLED EQUIPMENT

**BEFORE BEGINNING VERIFY DOWNSHOT ECONOMIZER CONFIGURATION
IF AIR FLOW IS HORIZONTAL DO NOT INSTALL POWER EXHAUST**

STEP ONE: PREPARATION

REMOVE FILTER ACCESS PANEL
LOCATED ABOVE WEATHERHOOD. SAVE
FILTER ACCESS PANEL FOR LATER USE

REMOVE ALL WEATHERHOOD PARTS
(SEE BELOW) EXCLUDING LEFT AND
RIGHT WALLS FOR POWER EXHAUST
INSTALLATION

PARTS TO REMOVE AND SAVE:

- HOOD ROOF
- HOOD FILTER CAP

PARTS TO REMOVE AND DISCARD:

- HOOD FILTERS (2)
- HOOD MIDDLE DIVIDER

FILTER ACCESS
PANEL (SAVE)

CARRIER UNIT

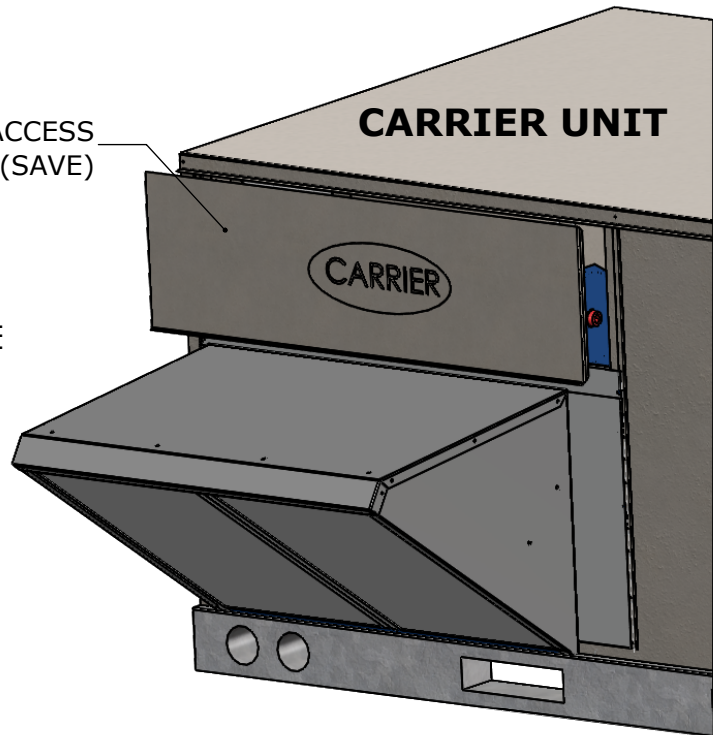

HOOD FILTER CAP
AND SCREWS (SAVE)

HOOD ROOF
(SAVE)

HOOD FILTERS
(DISCARD)

HOOD MIDDLE
DIVIDER (DISCARD)

CARRIER UNIT

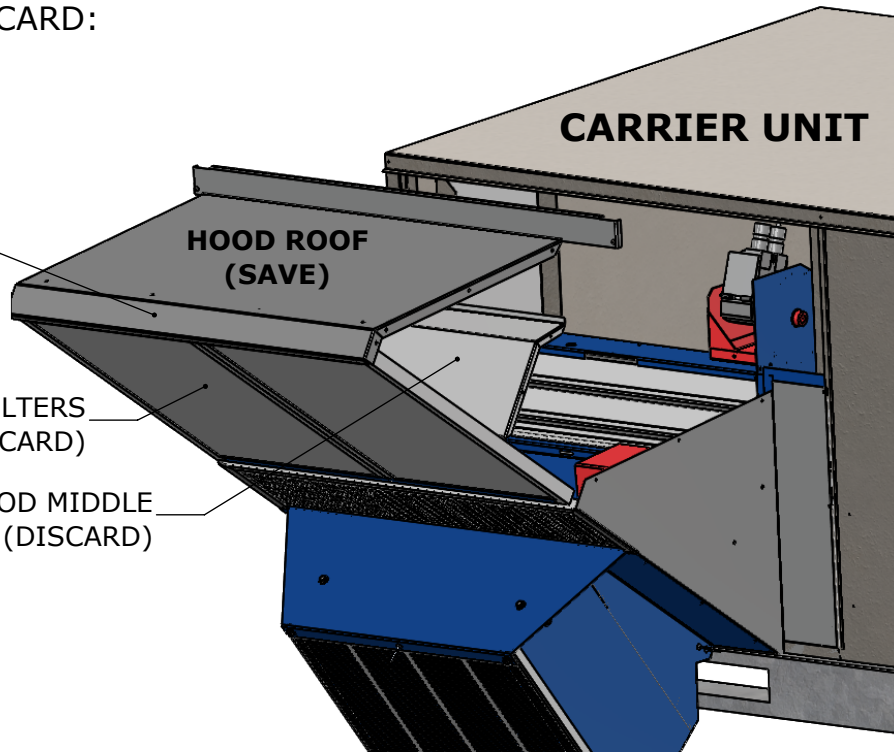

STEP TWO: INSTALLATION

I) SLIDE POWER EXHAUST INTO WEATHERHOOD. WEATHERHOOD WALL SIDE FLANGES WILL BE INSERTED INTO SLOTS PROVIDED IN THE POWER EXHAUST ON BOTH SIDES

SLOTS

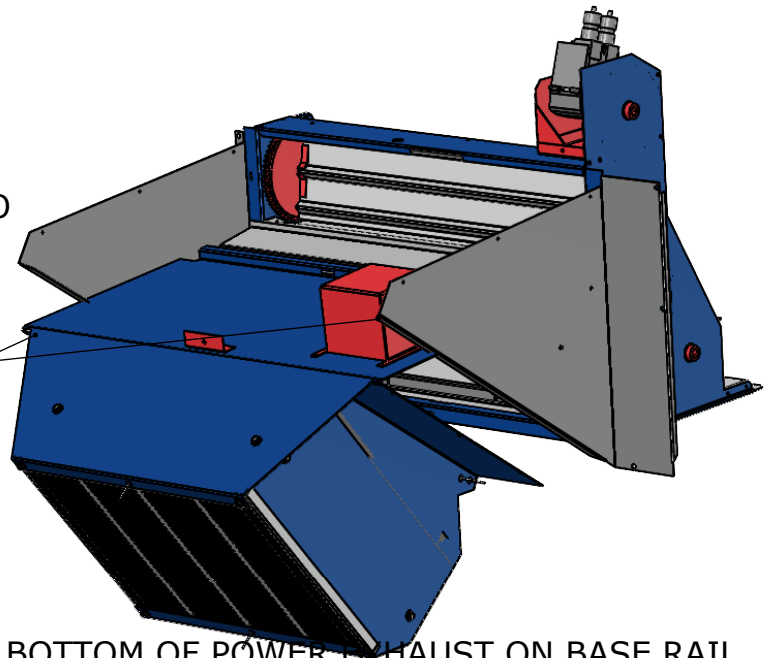

II) REST BOTTOM OF POWER EXHAUST ON BASE RAIL OF UNIT AND SCREW IN MIDDLE DIVIDER (3 PLACES) IMMEDIATELY TO TAKE LOAD OF ASSEMBLY

NOTE: SMALL 3A POWER EXHAUST CONTAINS ANGLE ON BACK OF POWER EXHAUST AND EXTRA HORIZONTAL BEND ON MIDDLE DIVIDER FOR EASE OF INSTALLATION

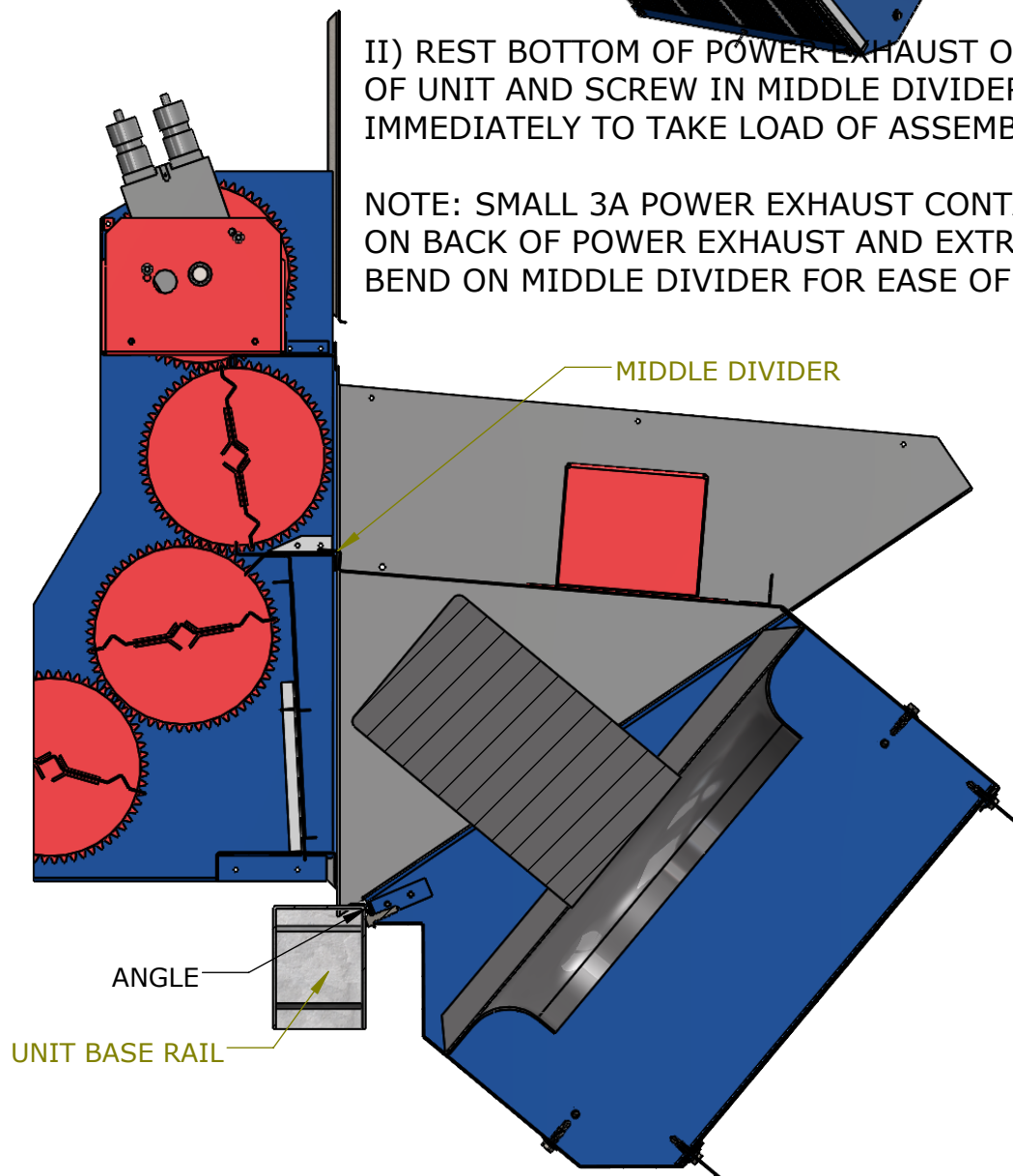

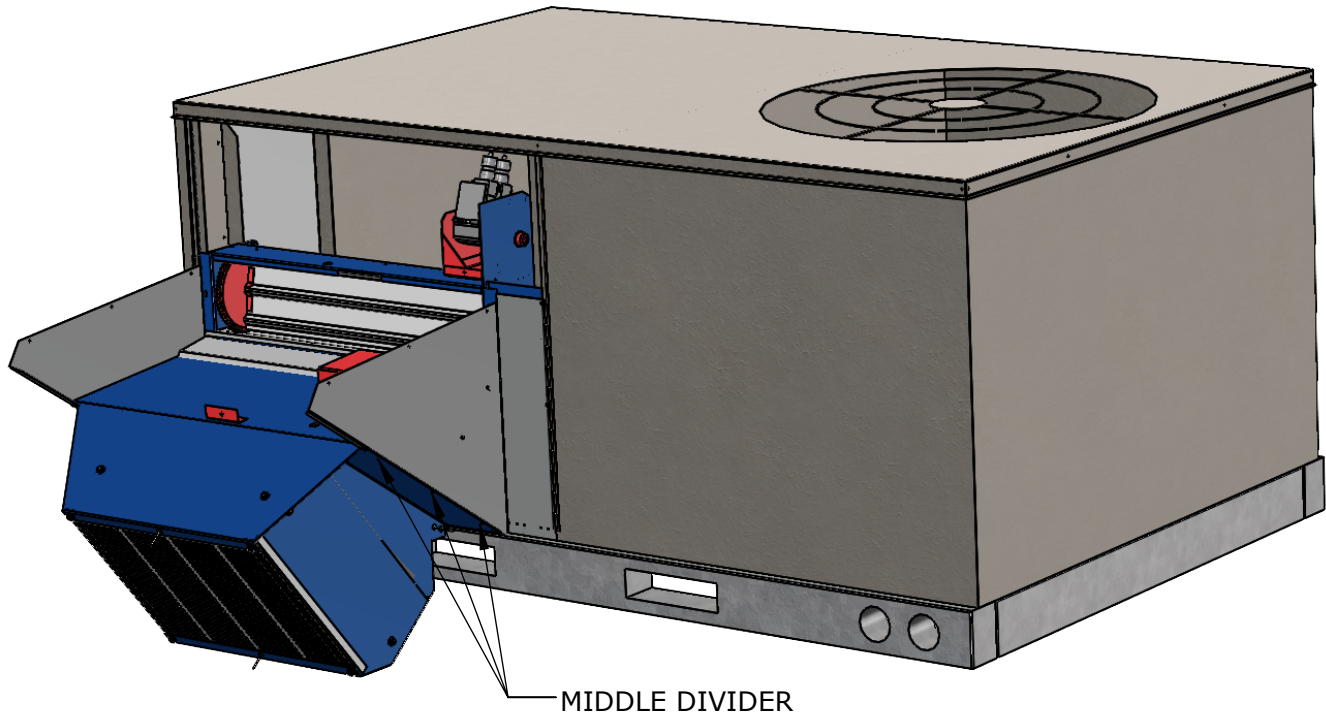

III) ATTACH POWER EXHAUST VIA THREE TEK SCREWS (SIX TOTAL) ON EITHER SIDE

STEP THREE: WIRING

REMOVE JUNCTION BOX PRE-ASSEMBLED AT C.A.S. TO ROOF OF WEATHERHOOD. CONNECT YELLOW WIRE LABELED "EX" AND BLACK COMMON WIRE FROM ECONOMIZER WIRING HARNESS TO CONTACTOR COIL

IMPORTANT!!! LINE WIRING TO THE POWER EXHAUST, DISCONNECT, AND FUSING TO BE SUPPLIED BY THE INSTALLING CONTRACTOR

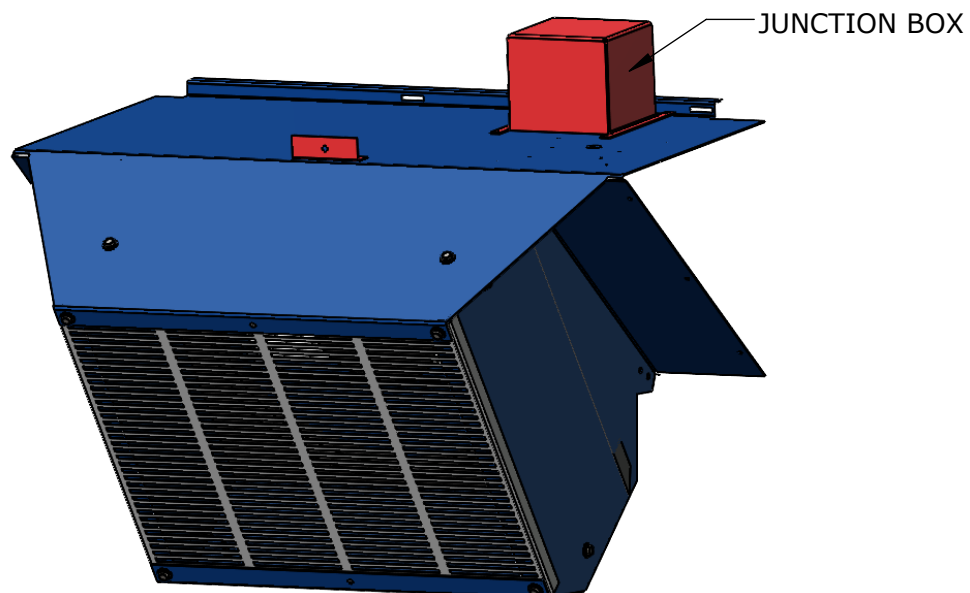

STEP FOUR: RE-ASSEMBLY

I) RE-INSTALL JUNCTION BOX AND WEATHERHOOD ROOF (REMOVED IN STEP ONE)

II) SLIDE FILTER INTO WEATHERHOOD TRACKS ABOVE POWER EXHAUST THEN REINSTALL FILTER RETAINER

III) RE-INSTALL FILTER ACCESS PANEL (REMOVED IN STEP ONE) ABOVE WEATHERHOOD

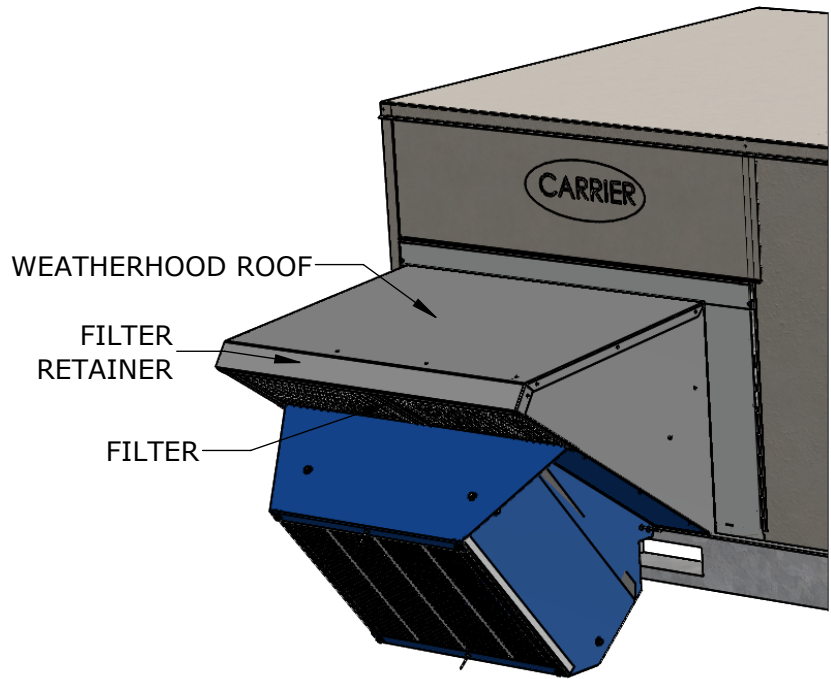

STEP FIVE: CONTROLLER SET UP

ON BELIMO ZIP CONTROLLER ARROW DOWN TO SETTINGS MENU, PRESS "OK", THEN ARROW DOWN TO FIND THE FOLLOWING SETTINGS



EXHAUST FAN ON POS = SET % OF ECONOMIZER O/A DAMPER OPEN THAT WILL ENERGIZE THE POWER EXHAUST

WHEN POWER EXHAUST IS USED IN COMBINATION WITH A 2 SPEED OR VFD SUPPLY FAN (STAGED AIR UNIT) AN ADDITIONAL SETPOINT IS REQUIRED

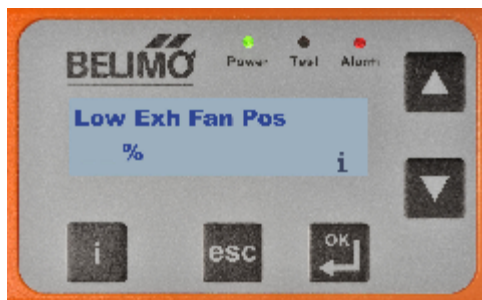

LOW EXH FAN POS = SET % OF ECONOMIZER O/A DAMPER OPEN THAT WILL ENERGIZE POWER EXHAUST WHEN BLOWER FAN IS RUNNING AT LOW SPEED