

STEP 1: BEFORE REMOVING UNIT, ENSURE THAT NO DUCTWORK IS CONNECTED TO THE UNIT. ONCE UNIT IS REMOVED, THE INSTALLING CONTRACTOR MUST INSPECT EXISTING CURB AND ROOF STRUCTURE TO MAKE SURE IT CAN SUPPORT THE NEW ADAPTER AND HVAC UNIT.

STEP 2: INSPECT TOP FLANGE AND DUCT SUPPORTS OF EXISTING CURB. IF ANY GASKETING OR SEALANT IS DAMAGED, IT MUST BE REPLACED (**FIELD SUPPLIED**)

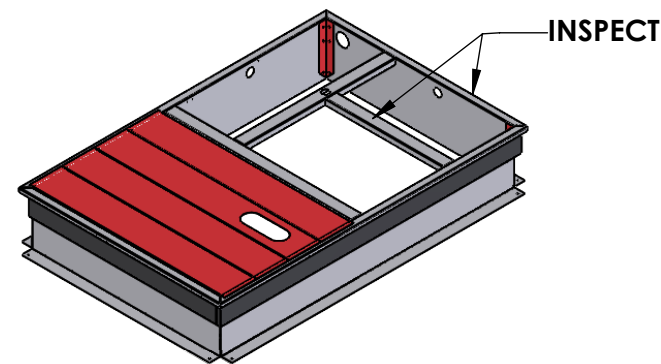

STEP 3: SET THE CURB ADAPTER DOWN ONTO EXISTING CURB ALIGNING THE SUPPLY AND RETURN AIR OPENINGS.

SECURE THE ADAPTER TO THE EXISTING CURB AND CAULK ALL AREAS WHERE LEAKS MAY OCCUR.

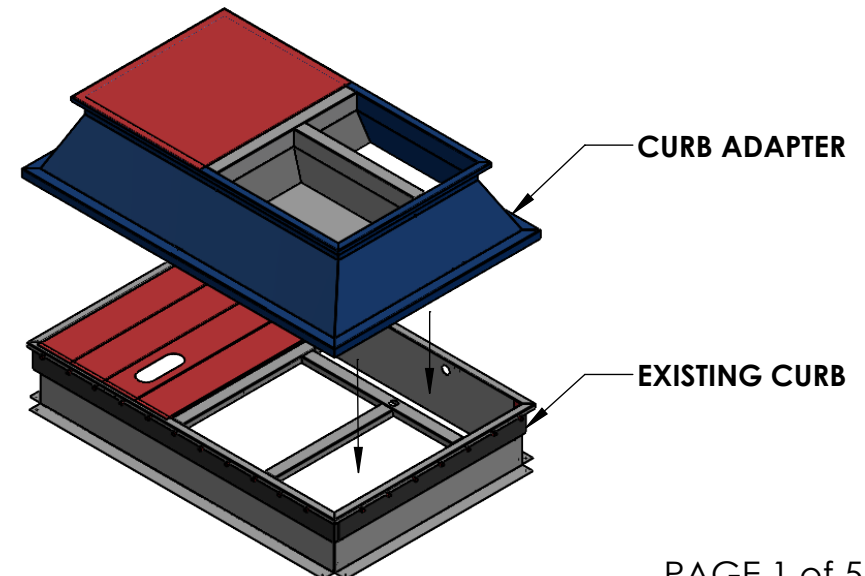

STEP 4: IF BLANK OFF PANELS ARE PROVIDED WITH THE ADAPTER, PLACE OVER REMAINING OPENING OF THE EXISTING CURB. FASTEN IN PLACE WITH TEK SCREWS NO MORE THAN 12" APART. ALL SEAMS MUST BE CAULKED WHERE LEAKS MAY OCCUR.

NOTE: APPLY WEIGHT ONLY TO SUPPORT CHANNELS LOCATED ON TOP OF BLANK OFF PANELS

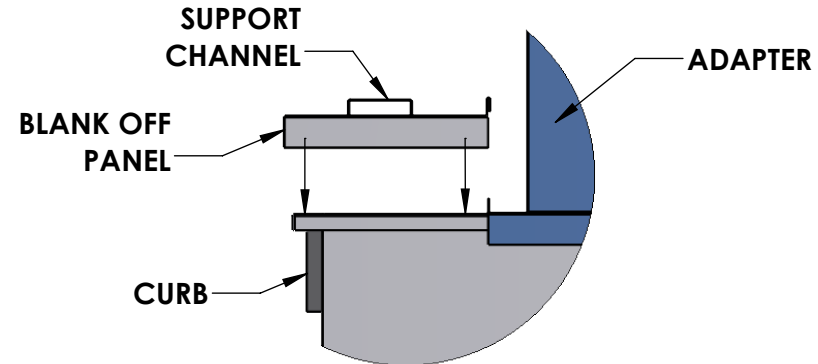
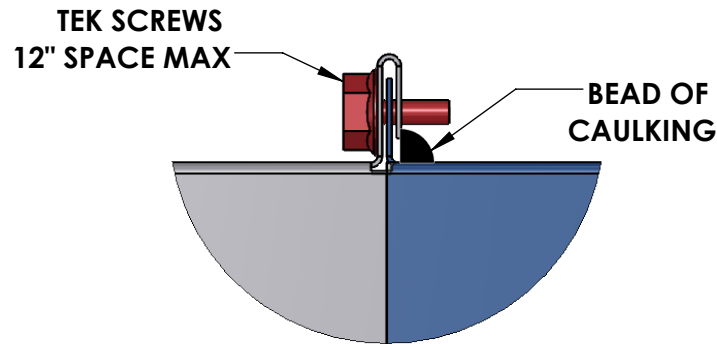

STEP 5: IF AN EQUIPMENT SUPPORT IS PROVIDED WITH THE ADAPTER, IT MUST BE PLACED UNDER THE SIDE THAT OVERHANGS THE EXISTING CURB. FIELD SUPPLIED SHIM MAY BE REQUIRED.

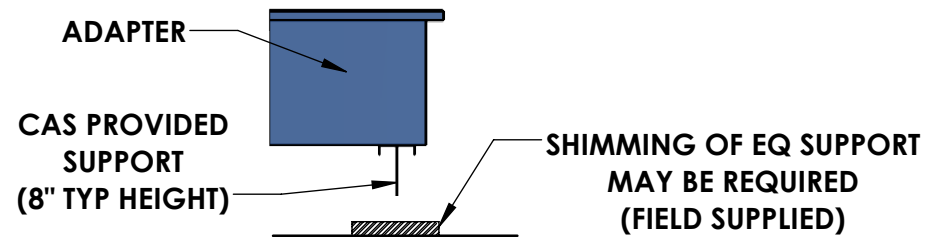

STEP 6: APPLY GASKET (PROVIDED WITH ADAPTER) TO THE TOP PERIMETER AND AIR OPENINGS OF THE ADAPTER. CAREFULLY SET THE NEW UNIT DOWN ONTO THE ADAPTER AND CHECK TO MAKE SURE IT IS FULLY SEATED.

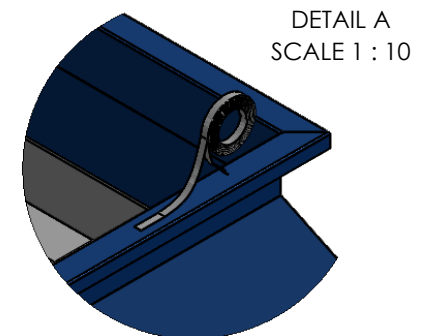
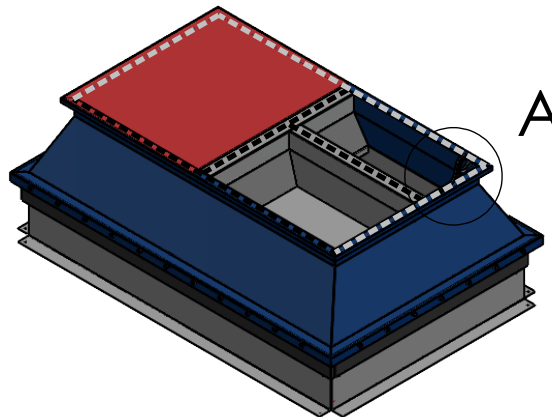

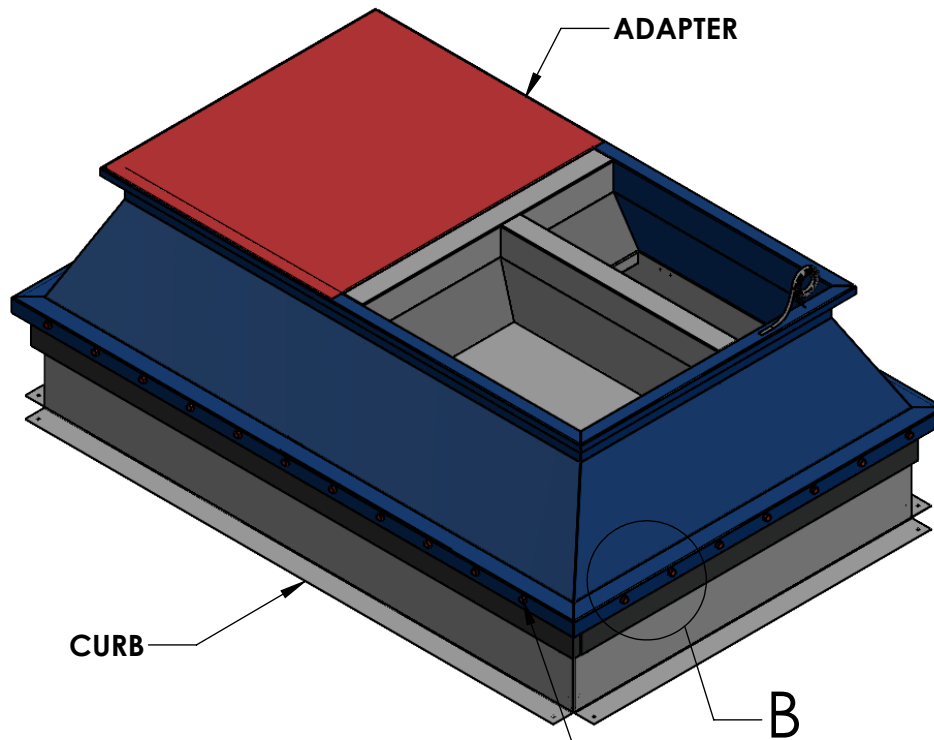

DETAIL B
SCALE 1 : 4

